



EZPAN edge-lit LED panels provide smooth, uniform edge-to-edge light for a clean, modern look. Install in drop ceilings or use optional surface, pendant or recessed (dry wall) mounting kits. Includes built-in support for Lightcloud wireless controls with SmartShift circadian lighting.

Color: White

Weight: 6.2 lbs

Project:	Type:
Prepared By:	Date:

Driver Info		LED Info	
Type	Constant Current	Watts	50W
120V	0.42A	Color Temp	2700-6500K
208V	0.25A	Color Accuracy	82-86 CRI
240V	0.21A	L70 Lifespan	75,000
277V	0.18A	Lumens	5256-5747
Input Watts	45.5-46.6W	Efficacy	115.3-123.7 lm/W

Technical Specifications

Lightcloud

Lightcloud Controller Installed:

Lightcloud provide wireless switching, dimming, scheduling, and power monitoring all from a cloud-based Web or phone App. [Learn more about Lightcloud.](#)

SmartShift

SmartShift:

SmartShift is the most advanced - yet easiest to use - circadian lighting system, which syncs white color tuning with the local sunrise and sunset. SmartShift is configurable down to the individual fixture for precision control and customization.

Listings

UL Listed:

Suitable for damp locations

CCEA Compliant:

Luminaire Requirements used in Environmental Air Space per the electrical code specification of the City of Chicago

IESNA LM-79 & LM-80 Testing:

RAB LED luminaires and LED components have been tested by an independent laboratory in accordance with IESNA LM-79 and LM-80.

Electrical

Dimming Driver:

Driver includes dimming control wiring for 0-10V dimming systems. Requires separate 0-10V DC dimming circuit. Dims as low as 10%.

Note:

All values are typical (tolerance +/- 10%)

LED Characteristics

Lifespan:

60,000-hour LED lifespan based on IES LM-80 results and TM-21 calculations

LEDs:

Long-life, high-efficacy, surface-mount LEDs

Construction

IC Rated:

Suitable for insulated ceilings

Maximum Ambient Temperature:

Suitable for use in -30°C (-22°F) to 50°C(122°F)

Lens:

Frosted Polystyrene

Mounting:

Recessed ceiling

Housing:

Lightweight aluminum housing, steel pan and junction box

Technical Specifications (continued)

Construction

Installation:

Standard integral T-bar clips secure the fixture to T-bars and prevent T-system separation

Finish:

Formulated for high durability and long-lasting color

Green Technology:

Mercury and UV free. RoHS-compliant components.

Other

Warranty:

RAB warrants that our LED products will be free from defects in materials and workmanship for a period of five (5) years from the date of delivery to the end user, including coverage of light output, color stability, driver performance and fixture finish. RAB's warranty is subject to all terms and conditions found at rablighting.com/warranty.

Equivalency :

Equivalent to (4)F32T8 or (4)F28T5

Buy American Act Compliance:

RAB values USA manufacturing! Upon request, RAB may be able to manufacture this product to be compliant with the Buy American Act (BAA). Please contact customer service to request a quote for the product to be made BAA compliant.

Dimensions

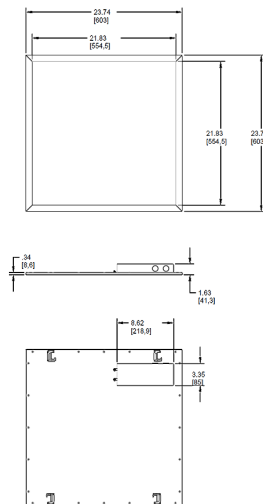

Features

Includes built-in support for Lightcloud wireless controls with SmartShift circadian lighting

Perfect for shallow plenums

Even and diffuse ambient illumination, ideal for spaces where glare-free lighting is required

0-10V dimmable driver, standard

Ordering Matrix

Family	Size	Dimming (standard)	Smart	Control Options
EZPAN	2X2	/D10	/SS	/LC
	2X4 = 2' x 4'	/D10 = 0-10V Dimming	/SS = SmartShift	/LC = Lightcloud® Controller
	2X2 = 2' x 2'			
	1X4 = 1' x 4'			