



Replace 200W and 250W MH lamps for wallpacks. Water/dust resistant. Uses 76% less energy than MH. 350° rotatable base puts light where you need it.

Color: White

Weight: 2.2 lbs

Project:	Type:
Prepared By:	Date:

Driver Info		LED Info	
Watts:	60W	Input Voltage:	100-277V
Color Temp:	4000K (Cool White)	Power Factor:	0.9
Lumens:	9,300	Flicker:	<30%
Efficacy:	155 LPW	THDi:	<20%
Color Accuracy:	80 CRI		
L70 Accuracy:	50,000		

Technical Specifications

Listings

UL Listed:

Yes

UL Classified:

Yes

FCC:

Yes

Rohs:

Yes

CEC Status:

Lawful for sale in California

DLC Qualified:

Yes

DLC Listed:

This product is on the Design Lights Consortium (DLC) Qualified Products List and is eligible for rebates from DLC Member Utilities.

DLC Product Code: PLTSD9J31E0U

Description

Lamp Type:

HID

Bulb Type:

Wall Pack

Base Type:

EX39, Mogul Base

Dimmable:

No

Construction

Operating Temperature:

-20 - 40°C

Bare Lamp Illuminated Length (inches):

7.56"

MOL (inches):

10.67"

MOD (inches):

3.62"

Minimum Compartment Size (inches):

Length: 7.87"
Width: 7.87"
Height: 11.81"

LED Characteristics

Lifespan:

50,000-hour LED lifespan based on IES LM-70 results

Other

Equivalent:

250W HID Wall Pack

Warranty:

5 years

Optical

Beam Angle:

180°

Shipping Information

Case Qty:

12

Case Dimensions:

16.73 x 12.68 x 12.6

Pallet Quantity of Pieces:

144

Pallet Dimensions:

27.32 x 35.43 x 42.52

HID-60-H-EX39-840-BYP-WP

Dimensions

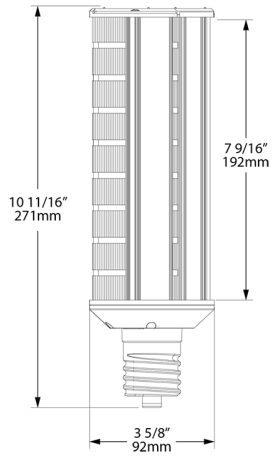

Features

- Uses 76% less energy than traditional lamps
- Integral Driver, Eliminates the Need for External Driver or Ballast
- Includes 4kV Surge Protection
- 350 ° rotatable base, directs light where needed
- Integrated Heat Sink Quickly Dissipates Heat
- Suitable for Use in Fully Enclosed Fixture
- Water and dust resistant, ideal for outdoor use
- Environmentally friendly: No Mercury Used